

### PARTS SUPPLIED

QTY	Description	
8	Polyurethane pivot bushings	A
4	7/8" od x 9/16" id x 2.50" sleeves	B
4	90 deg. zerk grease fittings (self tapping)	
2	9/16" tapered uniball spindle adaptors	E
2	9/16" upper uniball spacers	D
2	9/16-18 x 4.5" SHCS allen bolts	
2	9/16 SAE flat washers	
2	9/16-18 stover lock nuts	
4	Grease packets	
4	Camburg 8.5" 3C stickers	

Thanks for purchasing a set of Camburg uniball performance upper a-arms for your vehicle. Please follow all instructions. If you are not installing these yourself, have a qualified shop do so. These arms are designed to be used with stock unmodified spindles or Camburg performance lift spindles in conjunction with an approved 2"-3" lift bolt-in coilover. They are not to be used with other suspension kits or spacer type kits. Make sure to check the parts list to make sure you have every component prior to starting. Camburg Engineering has made every attempt to insure you receive the highest quality components in the most complete manner.

### Tools & Supplies Required

Eye protection | Jack | Jack Stands | Dead blow hammer | 21mm socket & wrench | 7/16" allen driver | 7/8" socket | 1/4" wrench | Torque wrench | Brake cleaner

### 1.0 Setup

Park the vehicle on level ground and set the parking brake and chock the rear wheels. Jack up the front end until the tires are off the ground. Place jack stands under the frame rails and set down. Jack up the driver side lower arm to only raise the tire off the ground, remove the wheel and keep jack under lower a-arm to support the suspension.

### 2.0 Removal

With needle nose pliers, remove the ABS speed sensor wire bracket from the backside of the upper arm. Be careful not to damage as the bracket will be re-used. Using a 21mm socket, loosen the nut from on the upper ball-joint where it connects to the spindle but do not fully remove. With a dead blow hammer strike the top of the spindle numerous times to release the ball-joint tapered stud. This can be a little difficult since it's a press fit, heating up the spindle to get it to expand will help. Once the ball joint releases from the spindle, then remove the nut. This will allow you to position the upper arm and spindle out of the way so you can remove the coilover/strut to access the upper arm bolts at the frame. Refer to your coilover instructions or service manual for details. Once the coilover is removed use a 21mm socket & wrench to loosen and remove the OEM upper a-arm bolts. Remove the stock upper arm.



### 3.0 Pre-installation

Using a 1/4" wrench install the self tapping zerk fittings into the Camburg arms. Now press the polyurethane bushings into the arms. Using the supplied grease, apply grease onto the OD of the inner pivot sleeves and press into the bushings. Wipe excess grease onto outer bushing face and apply additional grease if needed. Refer to diagram 3.1.

### 4.0 Installation

Install the driver side Camburg upper arm into the frame using the original hardware in the same orientation as it was removed. The arms are labeled but to insure you're installing the correct arm, the zerk fittings will be pointed upward, pivot gussets are on top, the uniball snap-ring below and the longer a-arm tube towards the front of the vehicle. Our arms are built with higher precision and tighter tolerances than the factory arms, so it will be a tighter fit into the frame. You may need to pry the outer tabs out very slightly to make it easier to install. When the stock arms are tightened from the factory it bends the tabs slightly in. Use a 21mm wrench and 21mm socket and torque to 110 ft/lbs. Refer to diagram 4.1

Prior to installing the tapered uniball adaptor spacer into the spindle, make sure the spindle taper is clean and free of debris. Install the lower spacer on top of the spindle with the taper fitting down into the spindle. Swing down the upper arm so the spindle adaptor inserts into the uniball. Insert the upper uniball spacer into the top of the uniball and bolt together with the supplied 9/16" bolt, washer and locking nut. Use red Loctite to keep the nut from loosening up. Using a 7/16" allen driver and 7/8" socket, torque to 120-125 ft/lbs. Make sure the spacers are fully seated in the uniball prior to tightening or damage will occur. Refer to diagram 4.2

Press the factory ABS speed sensor wire and bracket into the tab on the backside of the upper arm.

Repeat steps 1 through 4 to install passenger side arm

Due to the extreme and punishing nature of offroad use, Camburg Engineering products have no implied or expressed warranty. Camburg Engineering products and components are designed and manufactured for offroad use only. Installing most suspension products will raise the center of gravity of the vehicle and can increase the susceptibility to a rollover and alter the handling characteristics. Camburg Engineering products may void the vehicles warranty, check with your local dealer. The loss of use of the product, loss of time, inconvenience, removal, shipping costs, commercial loss or consequential damages are not covered. Camburg Engineering reserves the right to change the design, material or specifications of any product without assuming any obligation to modify any product previously manufactured and without prior notice. Every effort has been made to avoid printing errors and specifications. By installing and/or using these products you are accepting these stated conditions and accept all liability and responsibility.

### 5.0 Alignment

You will need to have your vehicle aligned by a qualified shop. Additional caster is built into the Camburg arms to correct alignment issues that are inherent with lifting the vehicle. Have your alignment shop increase caster from the OEM suggested specs, then set camber and toe to factory specifications. Having an increase in caster helps with straight line stability and cornering precision.

### 6.0 Maintenance & Care

Uniballs are a precision part with tight tolerances which can lead to occasional noise. Cleaning and lubricating them with WD-40 or a PTFE dry film can minimize that issue. Do not use harsh chemicals or grease that attracts dirt to clean & lubricate the uniball as it will damage the PTFE liner that is bonded internally. Over time the pivot bushings will also need to be cleaned and lubricated. Use grease that's designed specifically for polyurethane. We supply and sell a hi-temp, waterproof PTFE grease. Not using the correct grease can cause the bushings to squeak abnormally. The best method to grease the bushings is to remove the arms from the vehicle, disassemble, clean and lubricate. Some grease guns operate at 1300 psi. and can damage the bushings applying too much pressure.

Inspect and re-torque all hardware and components after 500 miles and whenever using the truck off-road.

### Notes

Recommended tire size: 33-37 x 12.50

Recommended wheel size: 17 x 8-9"

Maximum wheel backspacing = 5.75" (4.75" recommended with larger tires)

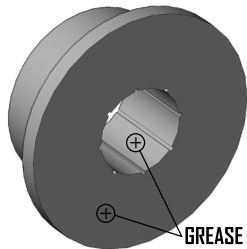

DIAGRAM 3.1

\*\* Torque bolts to 110 ft/lbs. \*\*

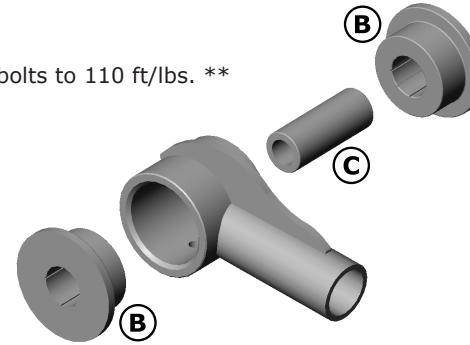

DIAGRAM 4.1



\*\* Torque 9/16" bolt to 120-125 ft/lbs. \*\*

DIAGRAM 4.2

Due to the extreme and punishing nature of offroad use, Camburg Engineering products have no implied or expressed warranty. Camburg Engineering products and components are designed and manufactured for offroad use only. Installing most suspension products will raise the center of gravity of the vehicle and can increase the susceptibility to a rollover and alter the handling characteristics. Camburg Engineering products may void the vehicles warranty, check with your local dealer. The loss of use of the product, loss of time, inconvenience, removal, shipping costs, commercial loss or consequential damages are not covered. Camburg Engineering reserves the right to change the design, material or specifications of any product without assuming any obligation to modify any product previously manufactured and without prior notice. Every effort has been made to avoid printing errors and specifications. By installing and/or using these products you are accepting these stated conditions and accept all liability and responsibility.